

# REPLACEMENT PARTS SUITABLE FOR TRAFIMET®

## R145™ (Hand) / R145P™ (Machine)

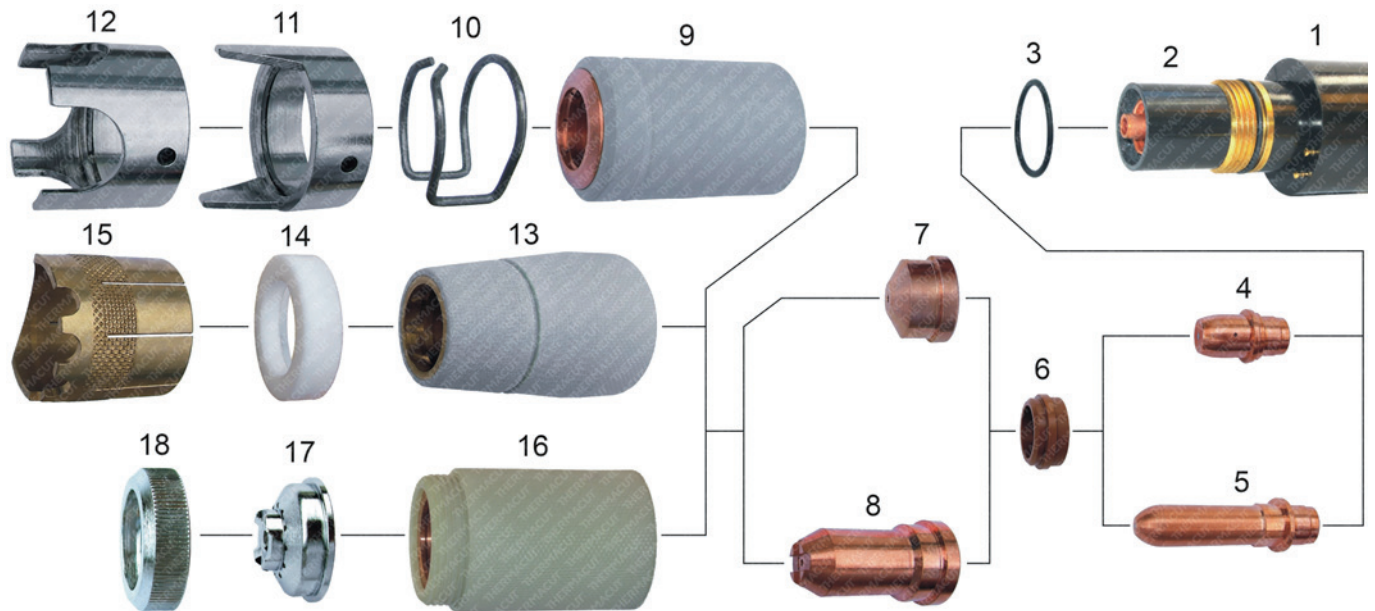

| Item | Part No. | Ref. No. | Description                    | Std. Pkg. | Item | Part No. | Ref. No. | Description                              | Std. Pkg. |
|------|----------|----------|--------------------------------|-----------|------|----------|----------|--|-----------|
| 1.   | T-5050   | PF112    | Torch Body, Hand               | 1         | 10.  | T-3718   | CV11     | Spacer Spring                            | 5         |
|      | T-5049   | PF111    | Torch Body, Machine            | 1         | 11.  | T-0643   | CV12     | Double Pointed Spacer                    | 1         |
| 2.   | T-11289  | T-11289  | Insulator (only for TMT torch) | 1         | 12.  | T-5003   | CV14     | Crown Spacer                             | 6         |
| 3.   | T-3562   | EA131    | O-Ring                         | 1         | 13.  | T-5017   | PC120    | Nozzle Retaining Cap                     | 1         |
| 4.   | T-5064   | PR111    | Electrode                      | 5         | 14.  | T-5000   | BW139    | Nozzle Shield                            | 10        |
| 5.   | T-5065   | PR116    | Electrode, Long – no thread    | 5         | 15.  | T-5001   | CV1105   | Cage Spacer                              | 1         |
| 6.   | T-5040   | PE103    | Swirl Ring                     | 2         | 16.  | T-5013   | PC103    | Contact Nozzle Retaining Cap             | 1         |
| 7.   | T-5027   | PD109-14 | Nozzle 1,4mm                   | 5         | 17.  | T-9371   |          | Spacer for Contact Cutting               | 1         |
|      | T-5028   | PD109-16 | Nozzle 1,6mm                   | 5         | 18.  | T-9375   |          | Locking Nut                              | 1         |
|      | T-5029   | PD109-18 | Nozzle 1,8mm                   | 5         | NS   | T-5069   | TP12     | Insulating Sleeve                        | 1         |
| 8.   | T-5032   | PD117-14 | Nozzle, Long 1,4mm             | 10        | NS   | T-5068   | TP10     | Handle with Switch                       | 1         |
|      | T-5033   | PD117-17 | Nozzle, Long 1,7mm             | 10        | NS   | KT-1446  | PA218    | Hand Torch 6m, fittings                  | 1         |
|      | T-5034   | PD117-19 | Nozzle, Long 1,9mm             | 10        | NS   | KT-1129  | PA250    | R145™ Hand Torch 6m, centr.conn.         | 1         |
| 9.   | T-10409  | PC101    | Nozzle Retaining Cap           | 1         | NS   | KT-1074  | PH151    | R145™ Cable Leads 12m, Hand, centr.conn. | 1         |

NS NOT SHOWN IN THE PICTURE

Last update of this page: 18/11/2016. See Revision history for details.

**THERMACUT®**  
THE CUTTING COMPANY

WWW.THERMACUT.CZ  
TEL.: +420 556 423 418  
SALES@THERMACUT.CZ

WWW.THERMACUT.DE  
TEL.: +49 (0) 27 39 40 33 0  
INFO@THERMACUT.DE

WWW.THERMACUT.COM  
TEL.: 1-603-542-6715  
CUSTOMERSERVICE@THERMACUT.COM

THERMACUT®, FHT-EX® AND EX-TRAFIRE® ARE REGISTERED TRADEMARKS OF THERMACUT, K. S. AND MAY BE REGISTERED IN CZECH REPUBLIC AND/OR OTHER COUNTRIES. ALL OTHER TRADEMARKS ARE PROPERTIES OF THEIR RESPECTIVE OWNERS. THERMACUT IS NO WAY AFFILIATED WITH TRAFIMET®. MOST THERMACUT PARTS ARE MADE FOR OR BY AN IBG COMPANY. PARTS INDICATED WITH A OEM ARE ORIGINAL PARTS MANUFACTURED BY THE ABOVE NAMED MANUFACTURER AND ARE BEING RESOLD BY THERMACUT. THERMACUT RESERVES THE RIGHT TO SUBSTITUTE OEM PARTS IN PLACE OF THERMACUT PARTS. VALID FROM JANUARY 2017 • PREVIOUS VERSION IS NO LONGER VALID. © COPYRIGHT 2017 BY THERMACUT® CZECH REPUBLIC. ALL RIGHTS RESERVED.